

TAIZHOU ECHOFAST MOULD CO., LTD.

SPEED&QUALITY

MAINTAIN A SUSTAINABLE COST ADVANTAGE FOR CUSTOMERS

WWW.ECHO-FAST.COM

COMPANY PROFILE

Taizhou Echofast Mould Co., Ltd. is a mold manufacturing company, which can provide molds and parts manufacturing services for customers. The company has won the recognition of our customers with accurate delivery time, better cost control and stable delivery quality.

The company has passed ISO9001:2015 International Quality Management System Certification and is a supplier of Envoy Pharmaceuticals and Haier Group. Meanwhile, the company has been continuously expanding its overseas business, and providing quality product manufacturing services for customers in South America, Africa, Southeast Asia, Europe and America.

The company is divided into 6 departments: design and development center, mold assembly workshop, die casting workshop, injection molding workshop, machining workshop and testing and management center. With a group of professional technical workers, advanced manufacturing equipment, perfect testing, and strong production supporting ability, our products have received countless favorable responses from customers at home and abroad.

The company insists on the market-oriented, quality-oriented and credit-supreme tenet, and invites customers at home and abroad to visit us for cooperation and suggestions!



DEVELOPMENT



Product and process development



Manufacturing feasibility study and analysis



Design and development of plastic parts and subassemblies



Development and manufacture of moulds and gauges



Project management

MANUFACTURING FEASIBILITY STUDY AND ANALYSIS

Based on our long-term practical experience in processing, we provide our customers with professional advice on part materials, surface textures, mechanical strength, fit, and tolerances, weighing prototype design and manufacturing costs to achieve the perfect balance.

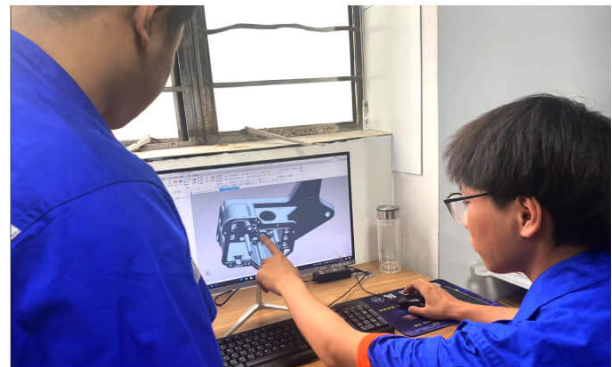
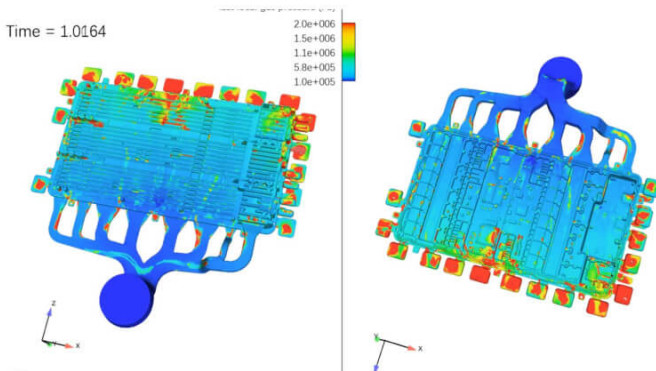

PROJECT MANAGEMENT

Based on the ISO 9001:2015 quality management system standard, we would provide you with real-time tracking of project progress, incorporating the concept of dynamic project management, timely error correction, and guaranteed delivery time.

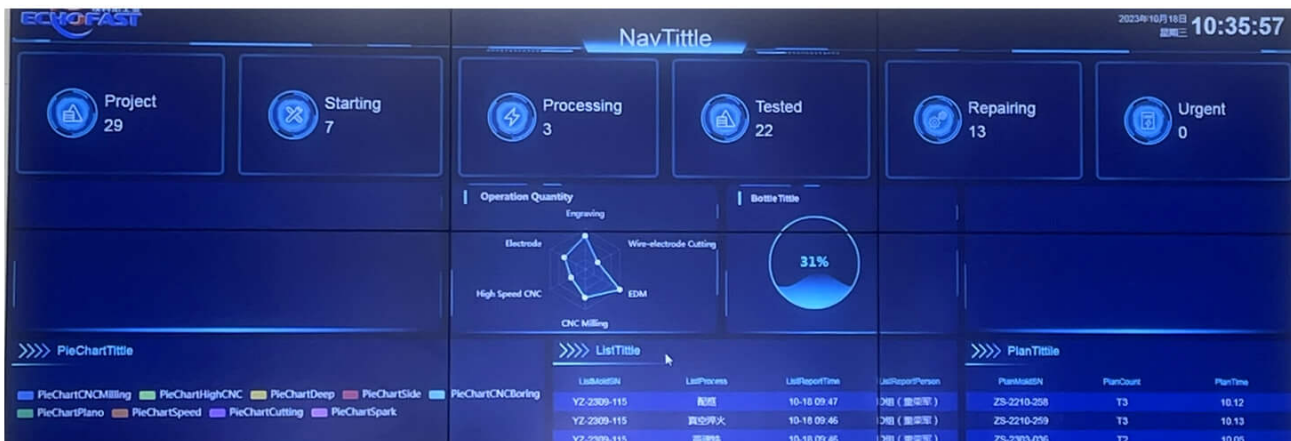

TECHNOLOGICAL CAPABILITY

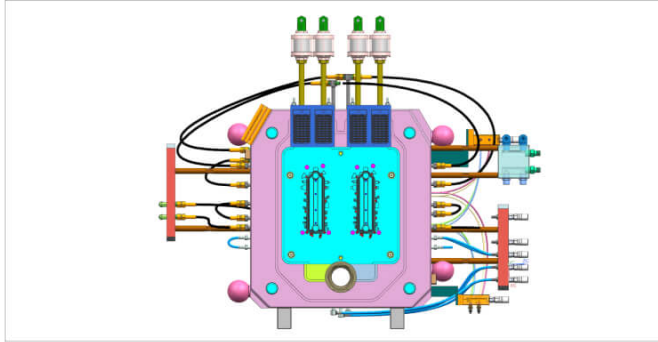

INVERTER COVER

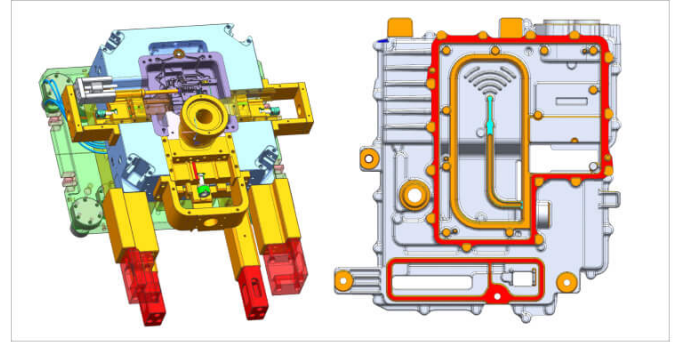

CONTROLLER HOUSING

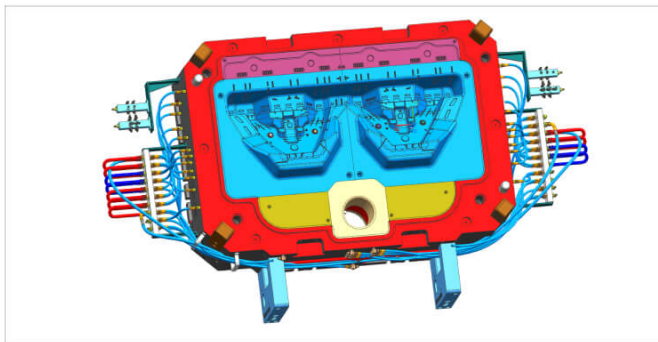

SHOCK ABSORBING TOWER

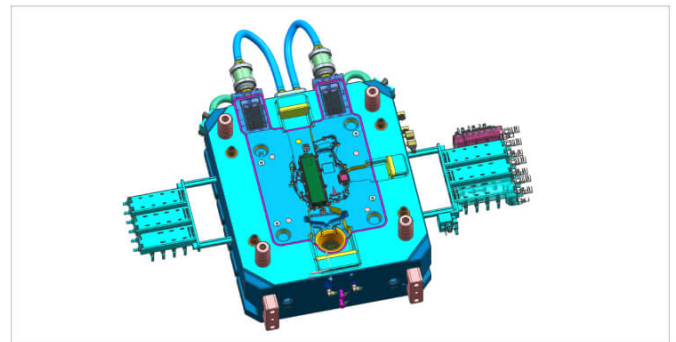

INVERTER HOUSING

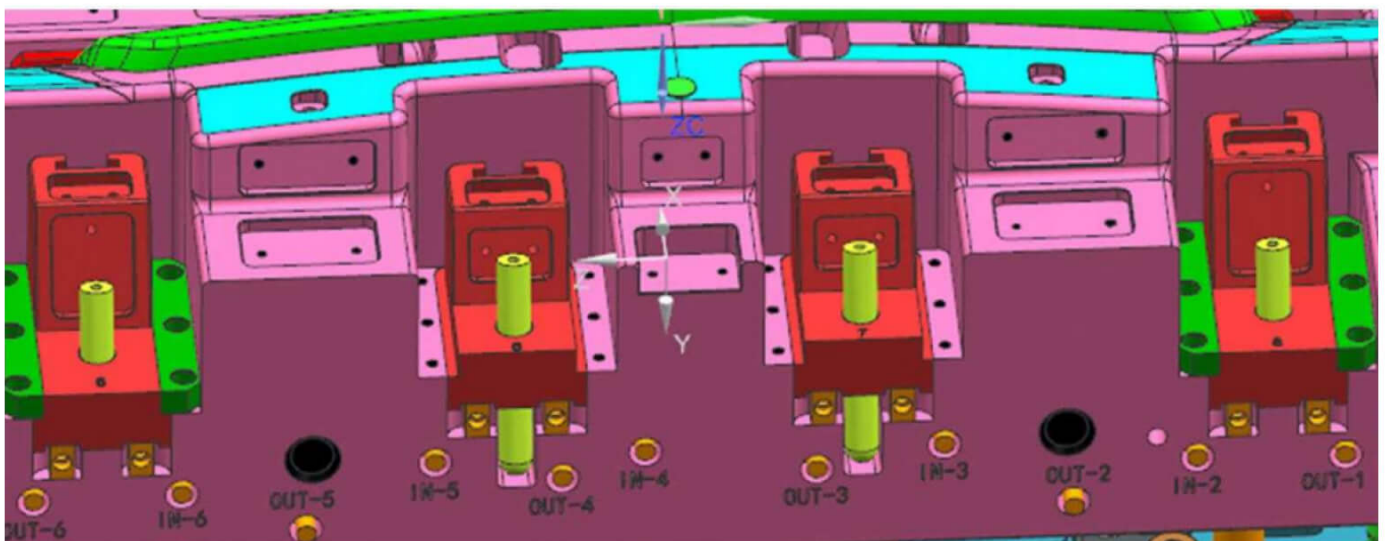

Core slides are mould components that can be slid in the mould opening and closing direction perpendicular to or a mould component that slides at a certain angle to the mould opening and closing direction.

EQUIPMENT DISPLAY

Development Equipment & Production Equipment

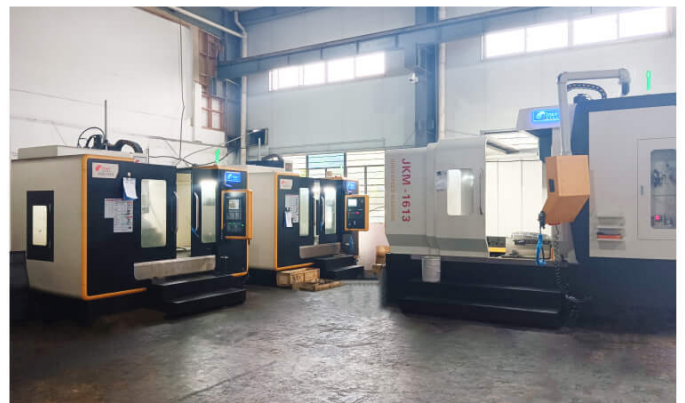

PRODUCT SHOWCASE

Automotive

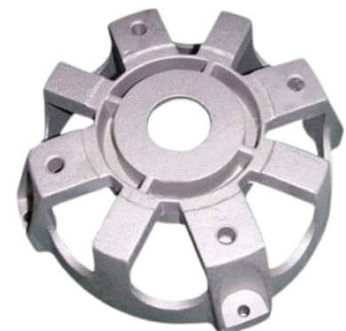
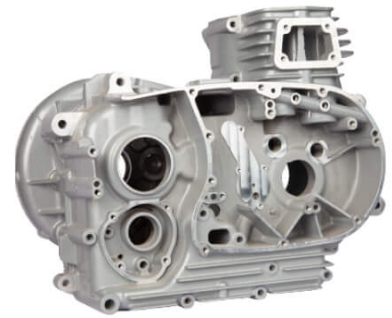
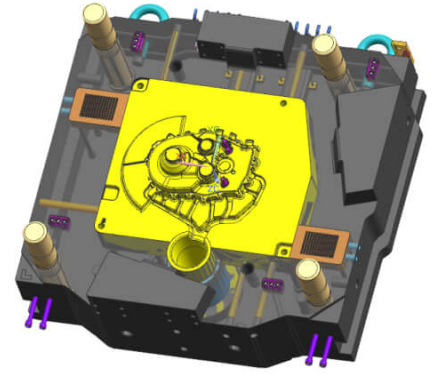
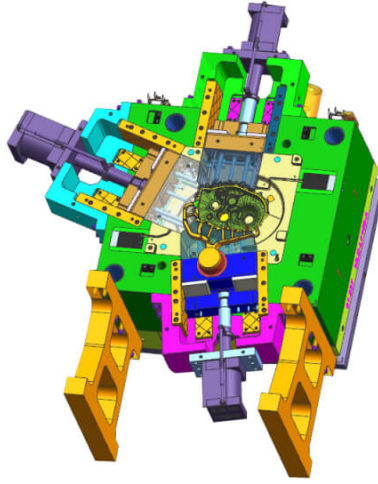

PRODUCT SHOWCASE

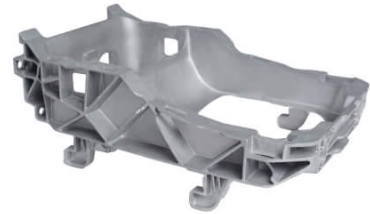
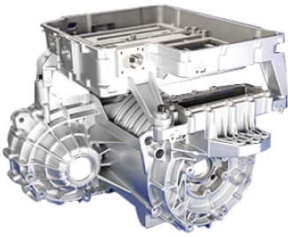
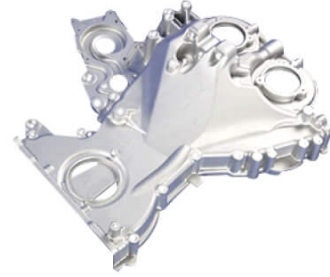
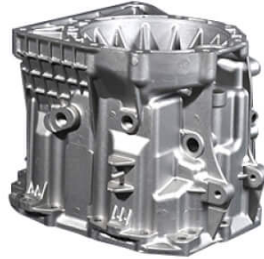

PRODUCT SHOWCASE

5G Communication Equipment Housing



PRODUCT SHOWCASE

Motor Housing



PRODUCT SHOWCASE

Pump Body & Valve



PRODUCT SHOWCASE

Security

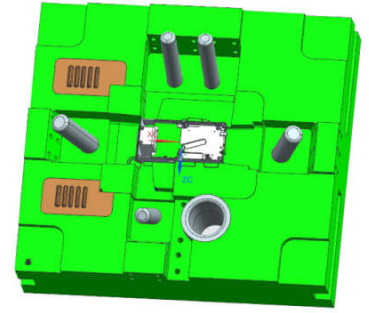
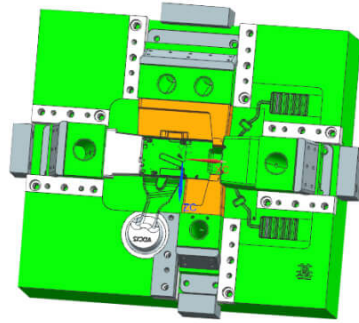

PRODUCT SHOWCASE

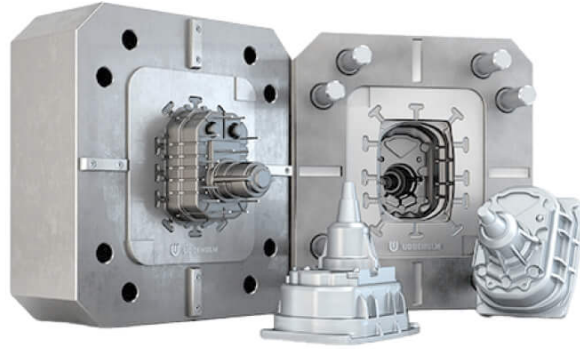

Others

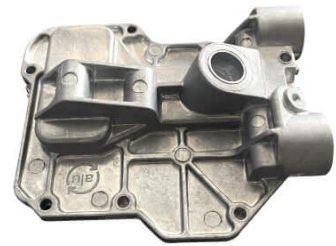

PRODUCT SHOWCASE

Copper Die Casting





TAIZHOU ECHOFAST MOULD CO., LTD.

E-mail : export@echofast.com Mobile:+86 13989613556

Address: 2-2 BEIYUAN AVENUE, BEICHENG STREET,
HUANGYAN, TAIZHOU, ZHEJIANG, CHINA